



Executive Committee of International Health Partners US

Dr. Dennis Lofstrom, COO and Vice President, Paula Lofstrom, Administrative Coordinator and Secretary and Mary Kitundu, President



# International Health Partners US

### Construction Details

- The Laboratory Building will be made of 22 pound interlocking bricks. The bricks are made of red soil and 10% cement and are very hard. The inside walls will be finished with white cement and the outside walls will be sealed with an acrylic sealer.
- The foundation will be one meter deep. This was determined by soil analysis.
- The laboratory is 3,840 square feet.. An estimation of \$35 square foot for construction that includes everything from footings, foundation, interior walls and roofing. .
- The Laboratory is estimated to cost \$134,000 to build. An additional \$163,000 will be needed.

### Construction

- We train our own workers for construction under supervision.
- Sometimes teams from the United States come to assist in the construction under the supervision of our contractor. We welcome them, especially, carpenters and plumbers, but almost anyone can assist.

### Personnel

- Sele Shabani is our contractor, Albert Kaali is our local architect. Dr. Dennis Lofstrom does all preliminary planning of the buildings to ensure patient flow and buildings which meet medical needs.
- PAMA Architects is our local architectural firm.
- A member of the executive committee is always at the site.

### IHP TZ and JEMA (IHP-JEMA )

IHP-TZ has joined with JEMA (another local NGO non-governmental organization) for the building of the children's hospital. They are invaluable in assisting with local and national regulations. The chair of JEMA is a local Tanzanian pediatrician who is esteemed throughout the country. Dr. Jesse Kitundu will also be the doctor in-charge of the hospital JEMA members are in charge of local fundraising. In addition new rules forbid foreigners from owning land, so partnering with JEMA is the answer. Both IHP US and the IHP-TZ boards whole heartedly approved it, and we are delighted to join together for the Children's Hospital.

Web site:  
[www.ihptz.org](http://www.ihptz.org)

US telephone  
870-404-4491

**US Address:**  
1811 South 39<sup>th</sup> Street  
#36, Mesa, Arizona,  
85206

**Tanzania Address:**  
PO 23102, Dar es  
Salaam, Tanzania



Beanie Babies help take the pain away...

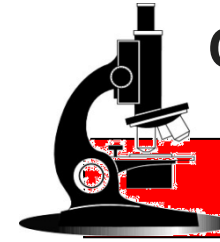

## Children's Hospital at Zinga, Tanzania

### Laboratory

An up-to-date laboratory is essential for giving quality care and for becoming a center of excellence.

Many dispensaries, health units and hospitals have minimal laboratory facilities. Some have only a cheap microscope. While the ability of a doctor to depend on his clinical skills is important, the backup of laboratory data can extend his ability immeasurably.

Although we might be able to draw blood under a mango tree, we cannot test the specimen there. So in addition equipment is also needed. We are appealing for good equipment for the lab.





IHP-US is a nonprofit international organization dedicated to creating partnerships between Tanzania and the world in order to improve healthcare.

### Why do we need this project at this time?

An up-to-date laboratory is essential for giving quality care and for becoming a center of excellence.

We will open with a small room and minimal lab equipment, but as a hospital, we will need much more.

The government desires that every place have adequate laboratory facilities. However, the building and equipment is very expensive. .

Personnel with laboratory skills are also important. We are in the process of educating and recruiting skilled workers. A scholarship for these people so they can obtain advanced skills is also needed.

This unit is needed now. If we don't build it, who will?

### How will it be financed?

IHP-JEMA owns the land, so there is no cost for land. In fact the 45 acres we own has a lot of room for this building.

The estimated cost of the laboratory is: \$134,000 or \$35 a square foot. To equip the Laboratory is an additional \$163,000.

We depend on **donors** to provide the money to build the Birthing Center. Sometimes several churches or organizations go together to fundraise for the building. Occasionally one person will provide enough money for the building. Sometimes entire town adopts a building.

We will call the Laboratory or laboratory rooms any name the donors provide.

For your information, we audit all our accounts every year both in the US and Tanzania and all the audits are clean and accurate. Copies are available upon request. We feel donors should always be assured that we are doing what we say we do and using your gifts as you would want them to be used.

### What can I do?

- Tell the story of the need for the pediatric hospital to friends, organizations and other people.
- Make a *designated* donation for the laboratory...once or monthly. To do this, mail a check to our US address. This is then placed in a special account so that your donation is only used for this building. Remember, we are building 20 buildings for the hospital.
- Pray for this project.
- Encourage family and friends to donate.
- Find other organizations or churches that would be interested in hearing the story. Dr. Dennis and Paula Lofstrom travel all over the United States and Canada and would be happy to show up and talk about the project. You can contact them at [paulalofstrom@ihptz.org](mailto:paulalofstrom@ihptz.org). Your emails will be answered promptly.

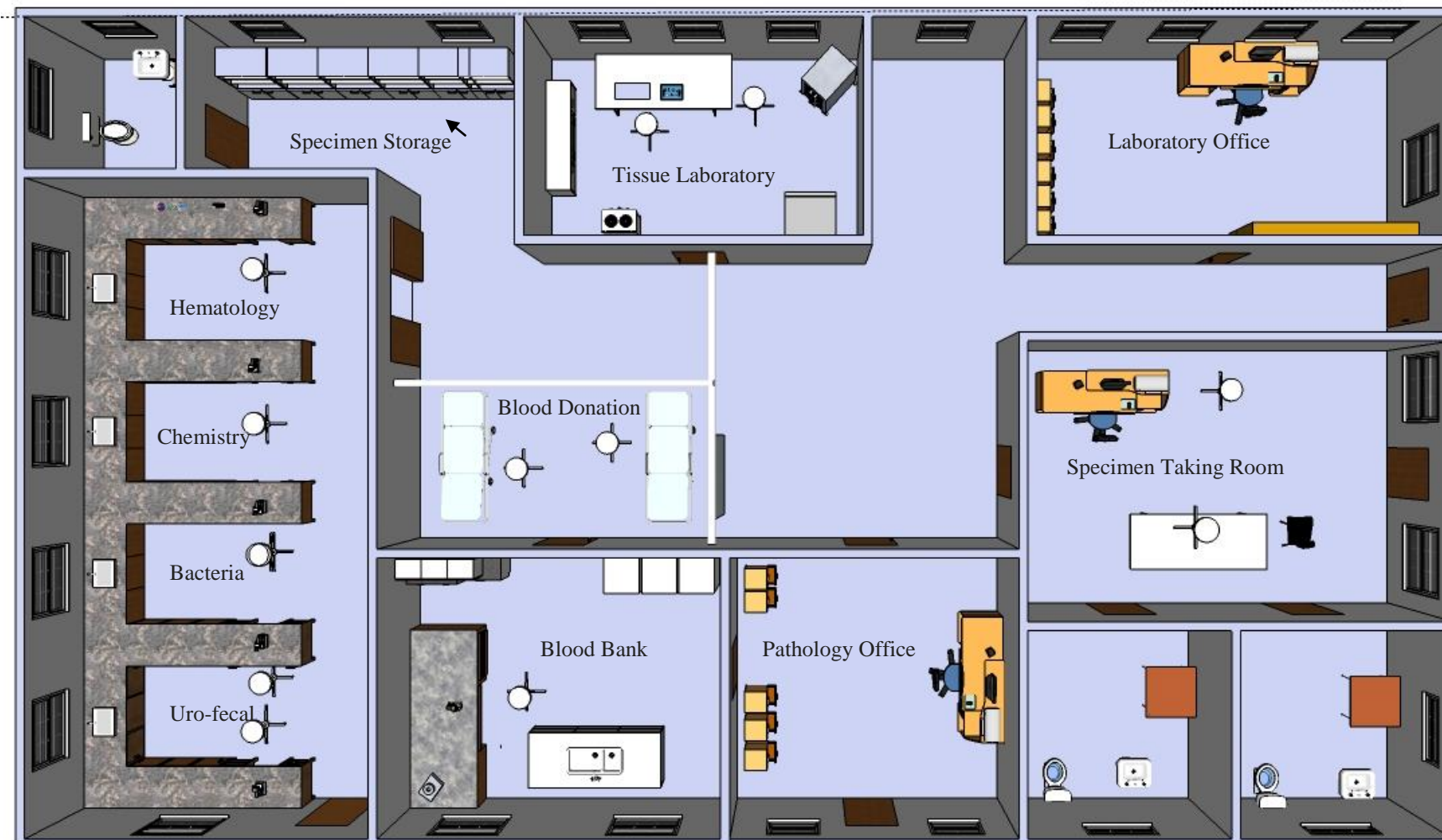

Visit our Website: [www.ihptz.org](http://www.ihptz.org)

Central Lab

Remember that there are 20 buildings. If you are interested in another building, email us at [paulalofstrom@ihptz.org](mailto:paulalofstrom@ihptz.org) for a copy of another brochure or go to our website for details.